



2/9 Ealing Crescent Springvale South VIC

3 2 2

A detached brick veneer 3-bedroom unit with land size 244m², the building size is 14 squares approximately, and built in 2005. A contemporary design highlights open plan living and privacy as Main bedroom is at the front and other two are at the back with great outdoor area for family activities.

Location is great. Few minutes' walk to Springvale library, boulevard, shopping center, 4 major banks, train station, and so many other facilities and amenities. Convenient access to schools.

The property is featuring with:

- ? Spacious master Bedroom with ENS & WIR.
- ? Reasonable size 2 Bedrooms with BIRs.
- ? Stainless Steel Gas Cooktop and Electric Oven.
- ? Brivis Central Heating System.
- ? Split AirCon System in living area.

Price : \$ 710,000
Land Size : 244 sqm
View : <https://www.leandco.com.au/sale/vic/south-east/springvale-south/residential/unit/6791197>



Phuc Le
03 8578 4200



Duncan Le
03 8578 4200

+ 2/9 EALING CRES SPRINGVALE

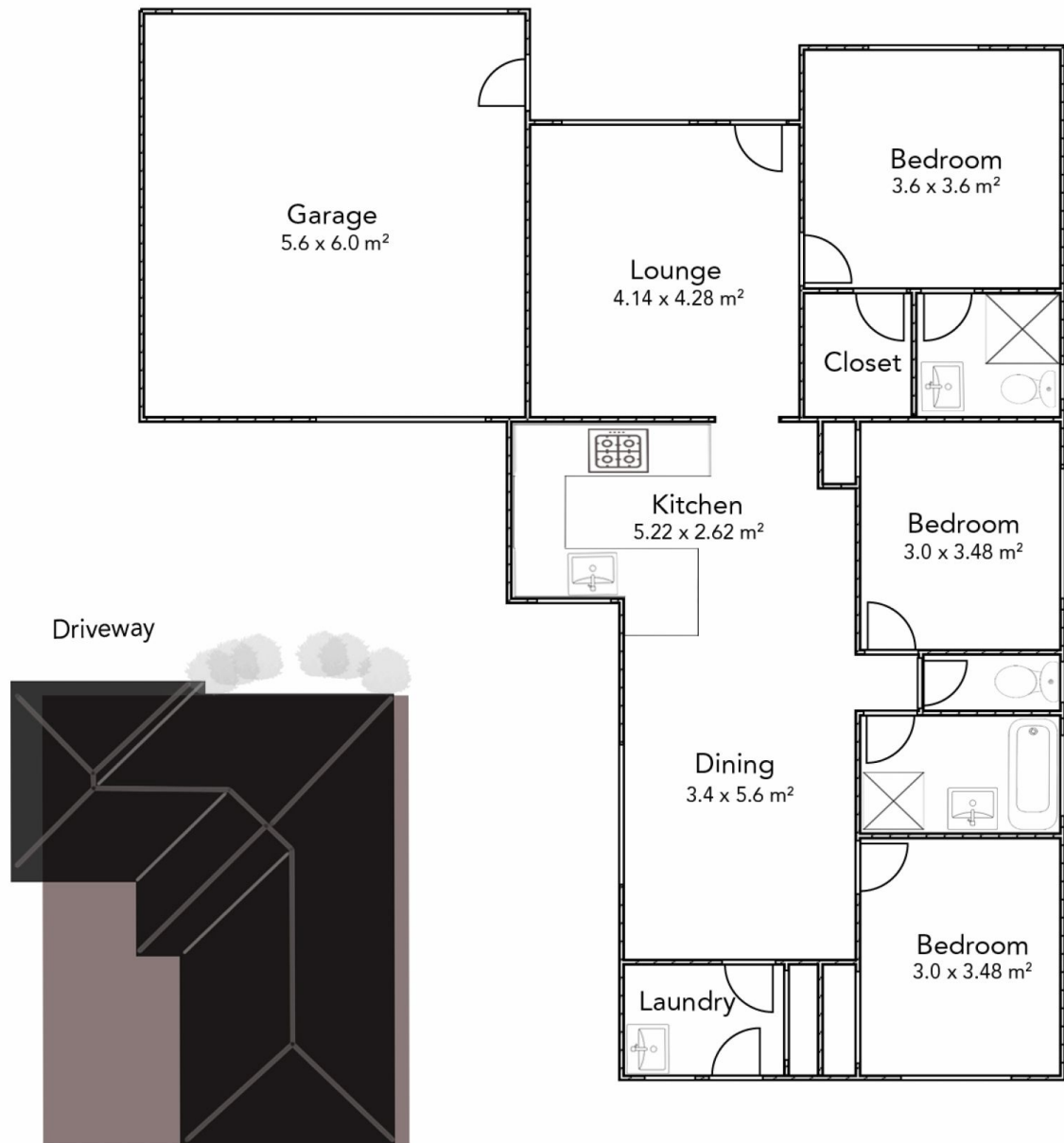

Approx. Site
244 m²



Disclaimer:

The floor plan is for illustrative purposes ONLY
All dimensions are to be confirmed on site.

