



105 Lightwood Road Noble Park VIC

Le & Co Estate Agents is pleased to offer 105 Lightwood Road, Noble Park for sale with Vacant Possession, suitable for owner occupiers and investors.

Located in the highly sought after Noble Park business precinct, close to Sandown Station and Springvale Station, moments from Springvale Road and Princes Hwy and Eastlink, 25km* South East of Melbourne CBD providing an abundance of nearby amenities.

KEY FEATURES:

- + Commercial Retail Shop/Office
- + High traffic of Lightwood Road
- + 600 car parking spaces across from Sandown Station
- + Rear laneway
- + Land area 260m2 approx.
- + Building area 220m2 approx.
- + Mixed Use Zone

Price : \$730,000 - \$780,000
Building Size : 220 sqm
View : <https://www.leandco.com.au/sale/vic/south-east/noble-park/commercial/other/7780078>





Phuc Le
03 8578 4200

Internal 128m²

105 Lightwood Road, **Noble Park**



2 x  1 x  1 x 

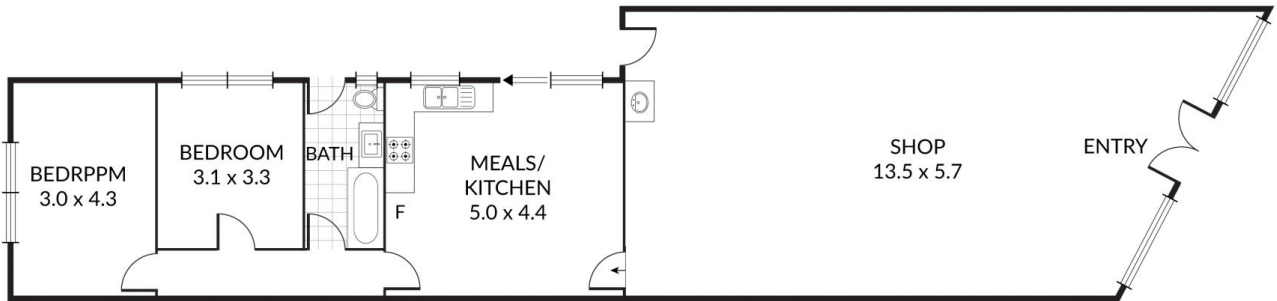

NOTE: Every precaution has been taken to verify the accuracy of the above details. However, prospective purchasers are advised to make their own enquiries.